

caddytek

CaddyLite ONE V3

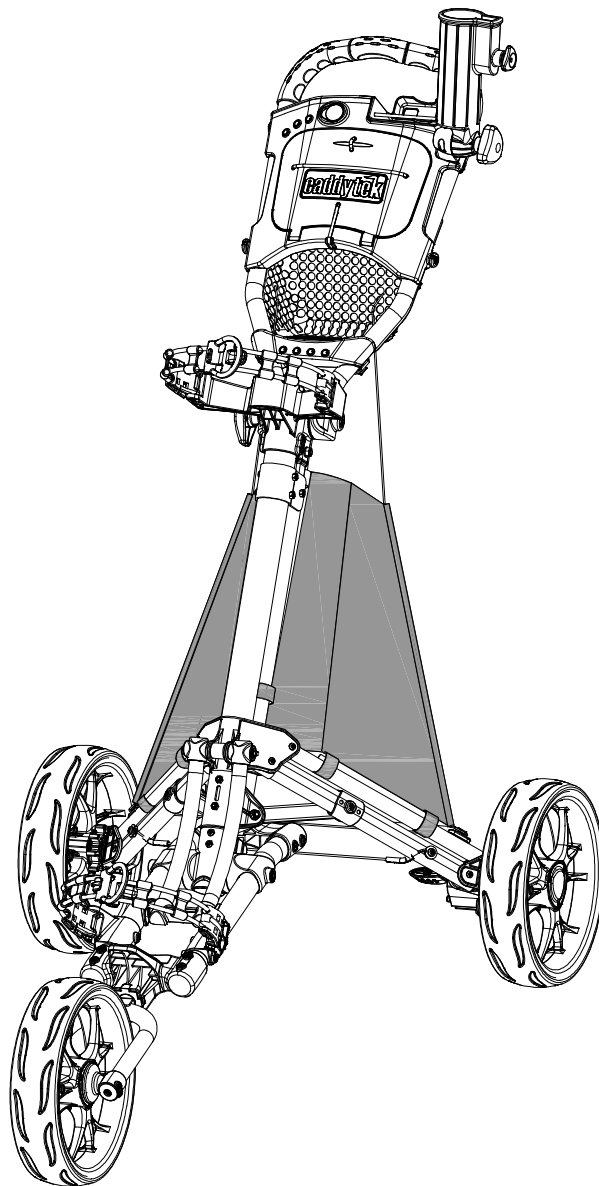

User's Manual

CaddyTek Inc.
20175 S. Atlantic Blvd., # C
Monterey Park, CA 91754, USA
www.caddytek.net

WARNING:

FOR YOUR OWN SAFETY, PLEASE REVIEW THESE WARNINGS AND KEEP THIS USER GUIDE FOR FUTURE REFERENCE.

- Before using this golf cart, please read and understand the important instructions and warnings in this user guide.
- AVOID injury by always following the folding and unfolding the cart instructions carefully
- AVOID INJURY by keeping clear of moving parts while adjusting, folding or unfolding this cart.
- ALWAYS make sure the cart is fully extended and locked before use.
- ALWAYS make sure the cart is folded and locked properly before lifting or transporting.
- ALWAYS use the brake when parking the cart.
- DO NOT run while using this cart.
- DO NOT use accessories other than those designed specifically for this cart.
- Keep hands and fingers away from moving parts or sliding sections of the cart!

Package contents:

1. The main frame of the cart
2. Two main wheels, front wheel
3. Umbrella holder
4. Drink holder
5. This user manual
6. Tools for adjustment

In case any of above item is missing or damaged, please call **800-906-6918** or email **caddytek@gmail.com** to report.

Parts identification:

- A: TPE handle grip
B: Umbrella holder
C: Umbrella holder base
D: Scorecard holder assembly
E: Basket with cooler
F: Handle frame
G: Upper bag holder bracket assembly
H: Handle height adjusting knob assembly
I: Main frame
J: Front connection Rod
J1: Main connection Rod
K: Leg frame bracket
L: 2 holes right leg frame
L1: 2 holes left leg frame
M: 4 holes right leg frame
N: Lower bag holder bracket assembly
O: Weight stabilizer
P: Supporting cable
Q: Main lower frame tube
R: Right wheel lock mechanism
R1: Left wheel lock mechanism
S: Rear wheel assembly
T: Lower bag holder bracket
U: Front wheel assembly
V: Foot brake assembly
W: Handle mesh net

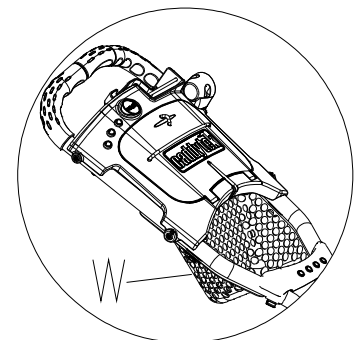
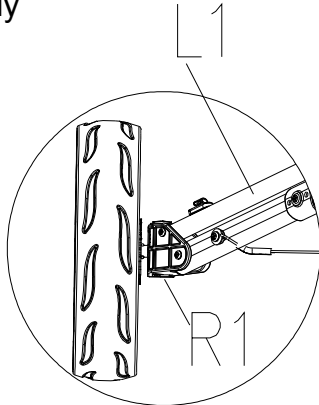
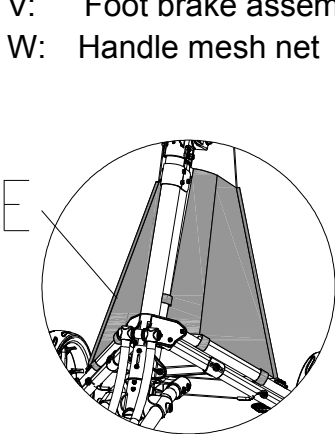
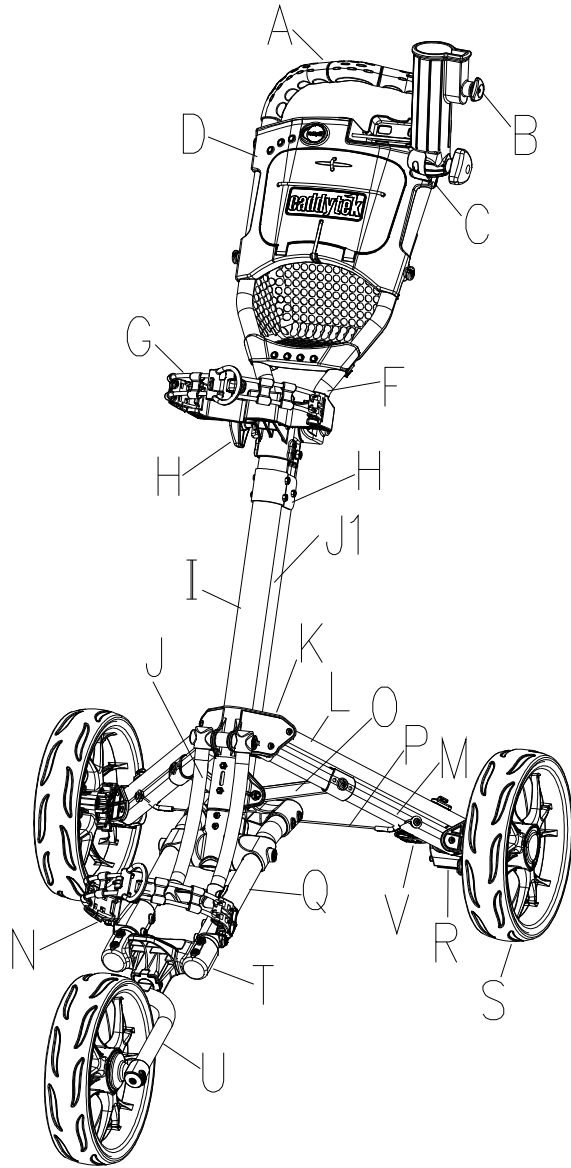

Assembly the car

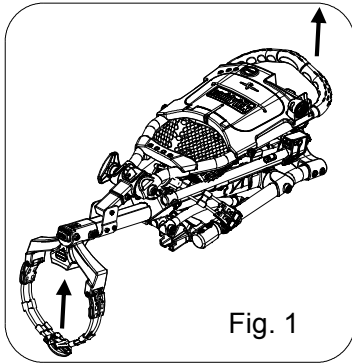

Open the handle up until you hear the cart 'Click' as in Fig.1

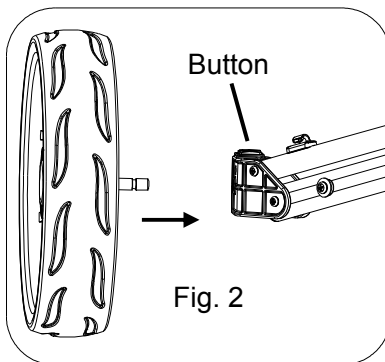
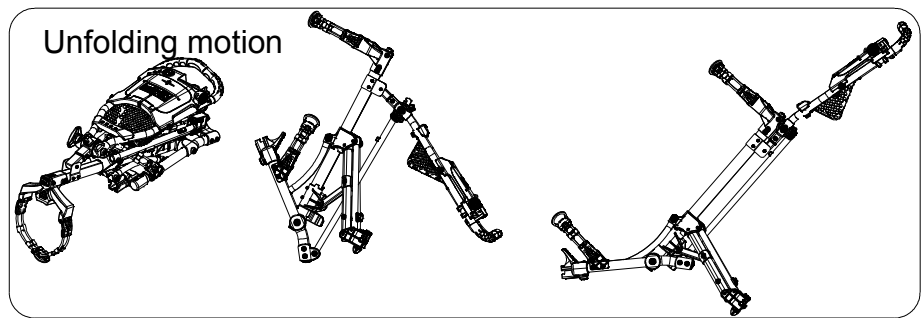

Press the button and insert the rear wheels as in Fig.2

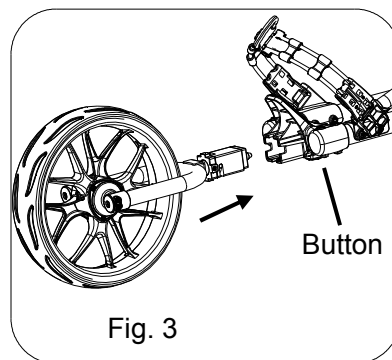

Press the button and insert the front wheel assembly as in Fig.3

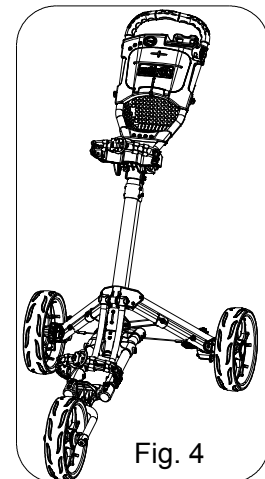

The cart is fully extended as shown in Fig.4

Folding the cart

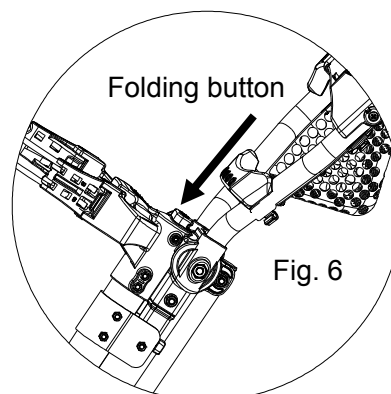
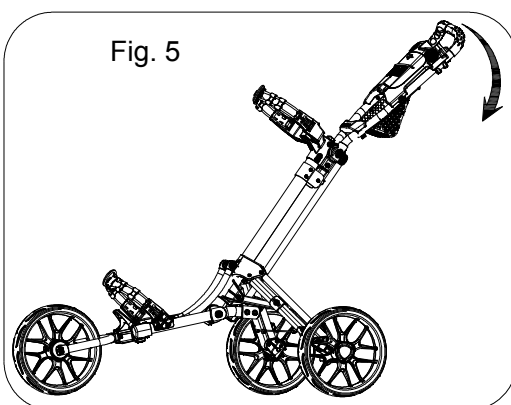

Press the button and fold the cart in the direction of the arrow as in Fig.5/6.

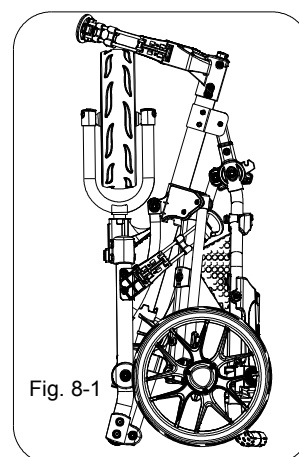
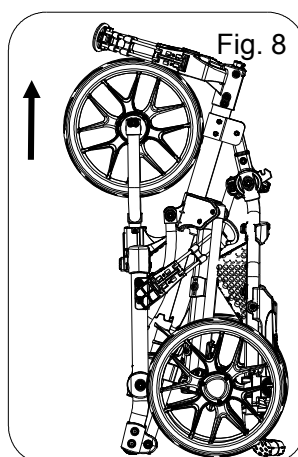
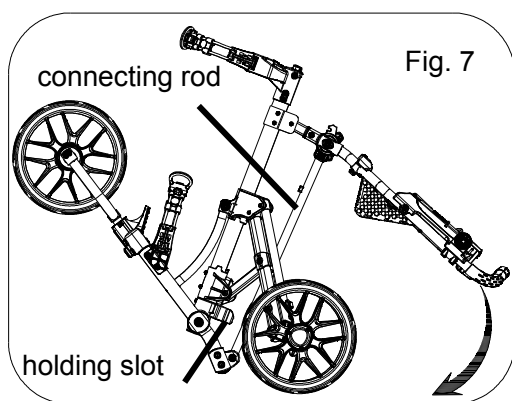

The connecting rod will insert into the plastic bracket when folding is completed as Fig. 7/8. Then pull up the front wheel assembly, then rotating 90 degree clockwise as Fig. 8-1.

Umbrella Holder

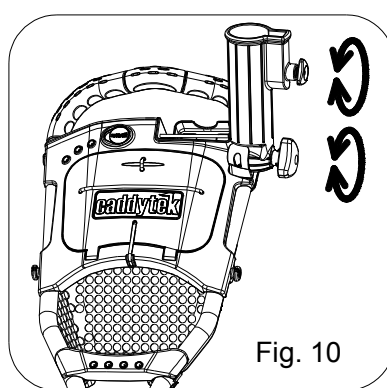
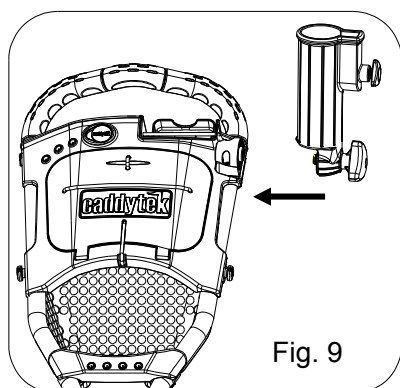

To put in use:
Simply attach the umbrella holder
onto the cart as in fig. 9/10

Use the brake

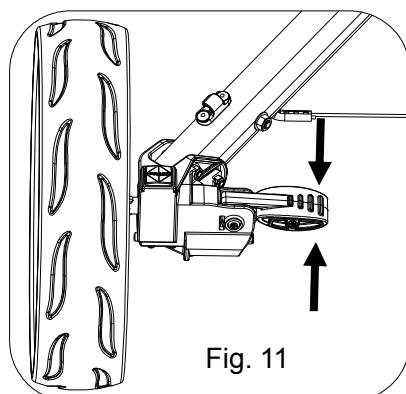

Press the footbrake to
brake, lift it up to release
as Fig. 11

To open the scorecard holder cover

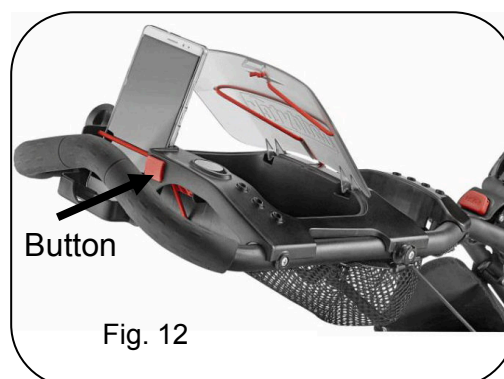

Press the button to open the scorecard
holder cover as Fig. 12

Front Wheel Alignment

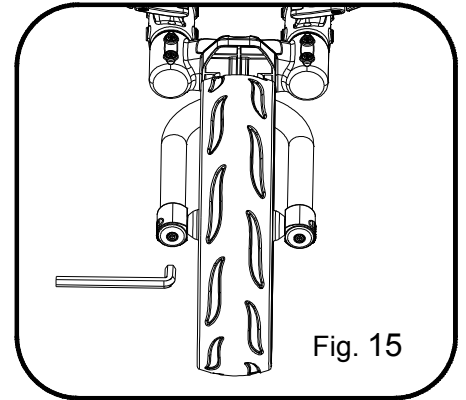
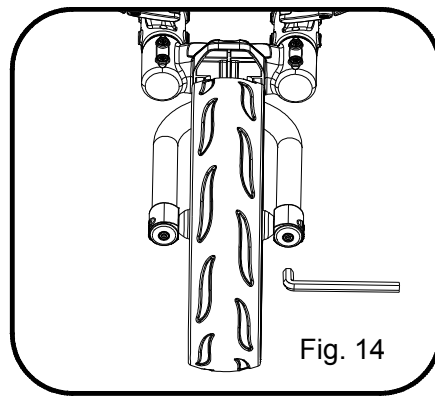
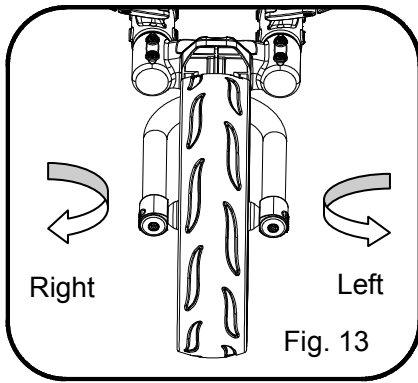

CART VEERING TO LEFT

If the cart veers to the left, face the front wheel and use the allen wrench provided to make the adjustments. You can either screw the left bolt clockwise, or the right bolt counterclockwise. Please continue doing so until the front wheel is centered.

CART VEERING TO RIGHT

If the cart veers to the right, face the front wheel and use the allen wrench provided to make the adjustments. You can either screw the left bolt counterclockwise, or the right bolt clockwise. Please continue doing so until the front wheel is centered.

WARRANTY

CaddyTek Inc. warrants its products to be free of defects and workmanship for one year from the date of purchase. We will either repair or replace defective products at our option.

Normal wear and fading of products are not considered manufacturer's defect. This warranty does not apply to claim of damage to items used in connection with CaddyTek Inc. products. In the case of deterioration due to normal use we will repair the item for a normal charge. CaddyTek Inc. is the sole judge of any claim or warranty.

For customers in North America, please contact CaddyTek Inc. for the service. For customers outside of North America, please contact with your dealer for the warranty service or you are welcome to contact CaddyTek Inc. directly.



PRODUCT REGISTRATION

I have read and understand this product's operation and warranty, and wish to record my purchase:

Model: _____

Name (Mr./Mrs./Miss): _____

Address: _____

City: _____ State: _____ ZIP: _____

Tel: _____ E-Mail _____

Date of Purchase: _____ Name of Store/Dealer: _____

Round of Golf per Month: _____ HCAP _____

Signed: _____ Date: _____

Failure to return this card may result in delayed response to you warranty claim

Stamp

Caddytek Inc.
20175 S. Atlantic Blvd., # C
Monterey Park, CA 91754
USA

You can also register your golf cart on www.caddytek.net

